



FP90 PUMP

Applications:

- Cutting, turning, milling, boring, grinding and similar applications of the machine tools,
- Cooling systems,
- Circulation systems. FP90 Pumps are used for pumping of cutting / cooling fluids.
- It has a peripheral impeller so it is recommended to use filtered fluid applications.

Fluid Specifications:

- Coolants,
- Cutting oils,
- Water,
- Fluid temperature 0...80 °C
- Kinematic viscosity 1...90 mm²/s

Materials:

Pump body	: Cast iron - DIN GG 25
Volute	: Cast iron - DIN GG 25
Impeller	: Brass
Pump shaft	: Engineering steel - AISI 1040 (DIN C35) Stainless steel- AISI 420(DIN X20Cr13) (Optional)
Electric motor	: 3 phase induction motor - 2 pole, Protection degree IP 55

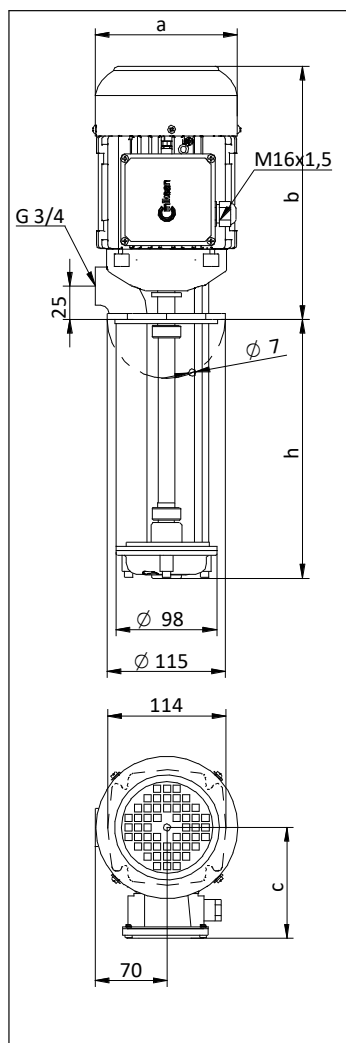

DIMENSIONS & NOMINAL VALUES

TYPE	Depth of immersion h (mm)	a	b	c	Weight kg	Power kW	Voltage V(Δ/Y)	Frequency Hz	Rated current A	Speed rpm
		mm								
		FP 90/11	110	138	240					
FP 90/15	150	138	240	111	10.9	1.1	230/400	50	4.85/2.8	2720
FP 90/20	200				11.2					
FP 90/25	250				11.5					
FP 90/30	300				11.8					

* Pump dimensions according to EN 12157.

** The performance curves are based on 1 mm²/s (cSt) kinematic viscosity values and 1000 kg/m³ density

*** Curve tolerance according to EN ISO 9906.

**** FP 90 pump has IE2 motor. According to IEC 60034-30-1:2014 standard this pump is excluded from efficiency class since its motor is completely integrated into the pump.

Performance Curve

